

## SS60-B-60(25) - SPEEDLINE System Data Sheet - Version V1 (24-10-23)

Staggered SPEEDLINE 60mm 'I' Stud Partition  
 @600mm Ctrs with 2x BG Gyproc 15mm  
 SoundBloc each side, 25mm APR

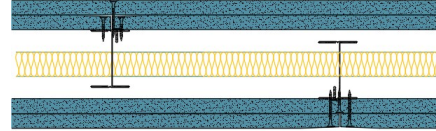

### System Performance Breakdown

Fire Resistance:

BS476 Part 22:1987:

Test Ref & Date or Applied Ref & Report:

Max Height:

Thickness:

Duty Grade: BS 5234: Part 2:1992:

Sound Insulation:

90/90 Minutes (Integrity/Insulation).

BRE Report P102396-1011A

Refer to Speedline Specification Clause

132 mm. (At Base Track, Excluding Finishes)

Severe - Annexes A-F

58  $R_w$  dB, -8 Ctr Date Tested or Assessed Against - 25/08/2011

Test Code:  
H17553AA  
Test Date:  
25/08/2011

Freq. Hz	R dB
50	25.5
63	18.6
80	25.4
100	35.4
125	34.8
160	40.3
200	50.2
250	50.6
315	52.8
400	57.5
500	60.1
630	62.6
800	65.0
1 000	66.8
1 250	67.7
1 600	68.5
2 000	64.1
2 500	55.3
3 150	56.9
4 000	62.0
5 000	64.7
6 300	
8 000	
10 000	

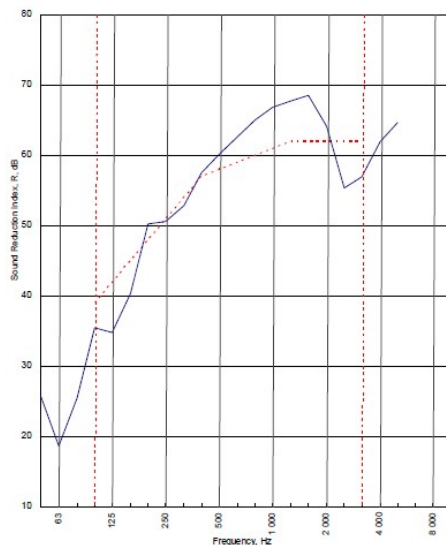

Rating according to BS EN ISO 717-1:1997	<b><math>R_w (C;Ctr) = 58 (-3;-8) \text{ dB}</math></b> Max dev. 7.2 dB at 125 Hz
Evaluation based on laboratory measurement results obtained by an engineering method:	$C_{50-500} = -7 \text{ dB}$ $C_{50-1000} = -6 \text{ dB}$ $C_{100-5000} = -2 \text{ dB}$ $C_{50-1100} = -18 \text{ dB}$ $C_{50-5000} = -18 \text{ dB}$ $C_{100-5000} = -8 \text{ dB}$

TESTED AT ONE OF THE UKAS  
ACCREDITED LABORATORIES  
BELOW

B.T.C  
(H-Ref on Graph)

B.R.E

AIRO

S.R.L



Customer: Metsec plc Hepsec Division

BTC 17553A: Page 9 of 11



SPEEDLINE Drywall Systems, Adsetts House, 16 Europa View, Sheffield Business Park, Sheffield, S9 1XH.

Tel: 0114 231 8030.

Email: [enquiries@speedlinedrywall.co.uk](mailto:enquiries@speedlinedrywall.co.uk)

(As per the requirements set out in ISO/IEC 17025:2017 regarding test data the results stated have been carried out by voestalpine Metsec plc as part of the contract to supply Speedline Metal Sections to SIG Plc)